

Disassembling

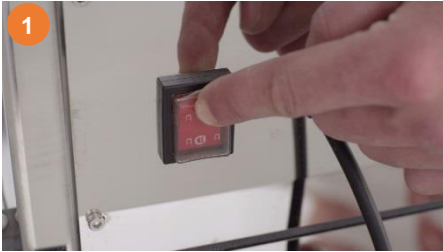

1 Ensure that no oranges remain in the machine. Turn off and unplug the machine before cleaning.



2 Remove **fruit basket** and **rotation plate**. Please clean the fruit tub accurately!



3 Remove the **splash protector** & the **side chutes** by pressing the fixation clip.

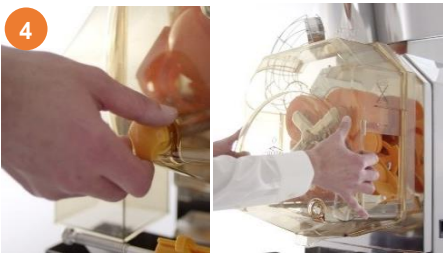

4 Remove the **front cover screws** & take off the **Front Cover**. **Not dishwasher!**



5 Remove the **Cross Holder** by loosening and pulling the screw.



6 Take off the **peel ejectors**.



7 Take off the upper and lower **pressing elements**.



8 Remove the **SCS knife** by moving it upward and pulling it off. **CAUTION! Risk of injury!**



9 Take off the **fruit supply tunnel** by opening the fixation lever.



10 Take off the **Double Cover**. Clean front with clear water and wet cloth.



11 Remove the **ATS-System**.



12 Remove, disassemble **SB-Tap** by unscrewing from machine. Remove **fruit sieve holder** (open screw)



13 Remove the **peel chutes** & if available the **bucket** below. (clean the peel disposal area)

! Recommendation!

For extra thorough cleaning use XON-Forte and put the parts in the dishwasher after a few minutes of exposure.



Assembling

Assemble the machine parts in reverse order. Ensure that the **Cross Holder screw** is fixed tightly. We recommend to clean the machine twice within 24 hours.

All machine parts, except the **Front Cover**, can be cleaned in the dishwasher.



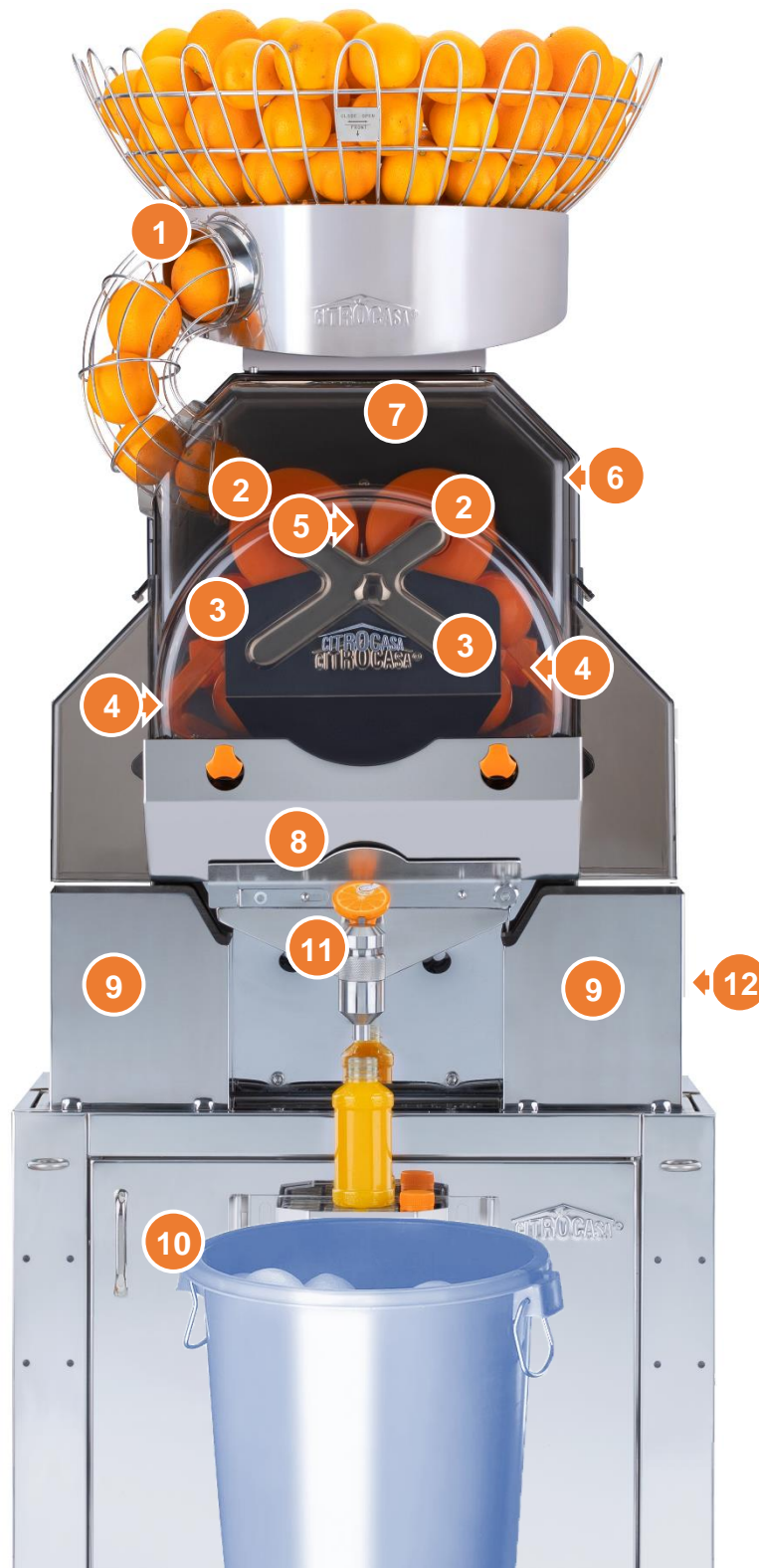

- | | | |
|--|-------------------------------------|----------------------------|
| 1 Supply Tunnel & Fruit Basket | 6 Double Cover | 11 Self-Service Tap |
| 2 2 x Upper Pressing elements (r & l) | 7 Front Cover & Side Chutes | 12 Main Switch |
| 3 2 x Lower Pressing elements (r & l) | 8 Fruit Sieve Support | |
| 4 2 x Peel Ejectors (r & l) | 9 2 x Metal Side Chutes | |
| 5 SCS Cutting Knife | 10 Cabinet incl. Peel Bucket | |