

## Disassembling



1 Ensure that no oranges remain in the machine. Turn off and unplug the machine before cleaning.



2 Remove **fruit basket** and **rotation plate**. Please clean the fruit tub accurately!



3 Remove the **splash protector** & the **side chutes** by pressing the fixation clip.

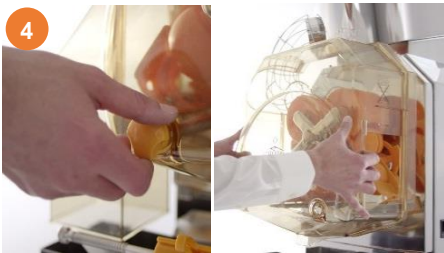

4 Remove the **front cover screws** & take off the **Front Cover**.  
*Not dishwasher safe!*



5 Remove the **Cross Holder** by loosening and pulling the screw.



6 Take off the **peel ejectors**.



7 Take off the upper and lower **pressing elements**.



8 Remove the **SCS knife** by moving it upward and pulling it off.  
**CAUTION! Risk of injury!**



9 Take off the **fruit supply tunnel** by opening the fixation lever.



10 Take off the **Double Cover**. Clean front with clear water and wet cloth.



11 Remove the **MTS-System** and disassemble the **MTS-Pusher**. (by pressing the fixation clip)



12 Unscrew cap-screw to remove **fruit sieve holder**. Then remove the **juice tank** from the machine.



13 Remove the **peel chutes** & if available the **bucket** below. (clean the peel disposal area)



### ! Recommendation!

For extra thorough cleaning use XON-Forte and put the parts in the dishwasher after a few minutes of exposure.



## Assembling

**Assemble** the machine parts in reverse order. Ensure that the **Cross Holder screw** is fixed tightly. We recommend to clean the machine twice within 24 hours.

All machine parts, except the **Front Cover** and **XB-Tank**, can be cleaned in the dishwasher.



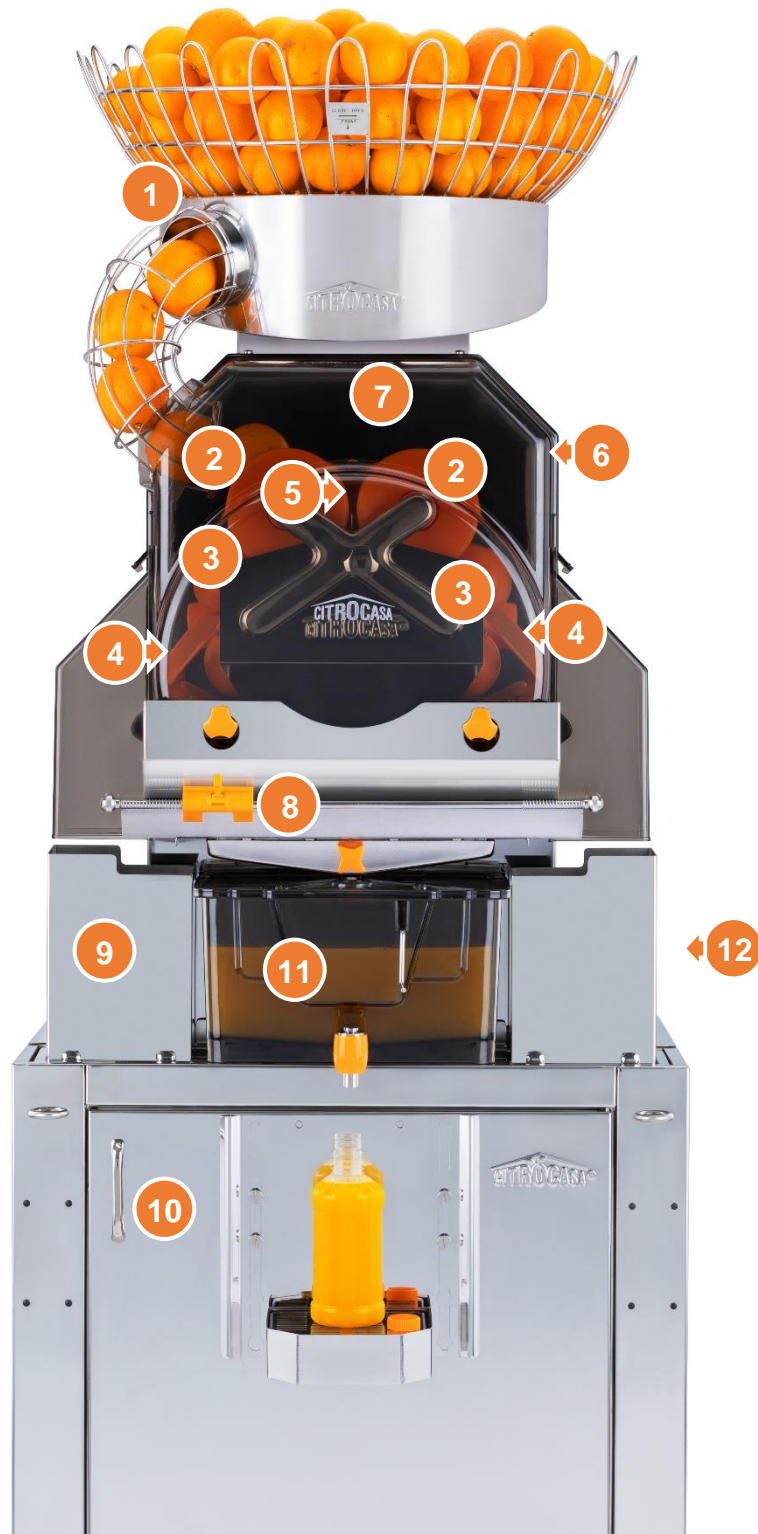

- |                                       |                              |                |
|---------------------------------------|------------------------------|----------------|
| 1 Supply Tunnel & Fruit Basket        | 6 Double Cover               | 11 Juice Tank  |
| 2 2 x Upper Pressing elements (r & l) | 7 Front Cover & Side Chutes  | 12 Main Switch |
| 3 2 x Lower Pressing elements (r & l) | 8 Fruit Sieve Support        |                |
| 4 2 x Peel Ejectors (r & l)           | 9 2 x Metal Side Chutes      |                |
| 5 SCS Cutting Knife                   | 10 Cabinet incl. Peel Bucket |                |