



Total Food-Service Solutions

## Modular Cooking –Oriental

### GasWok Range

#### NGWR 9-90 W1S1



\*Due to routine technical improvement, the photograph shown may not represent the latest design of the products.

#### AVAILABLE MODEL

1. NGWR 9-90 W1S1

#### DESCRIPTION

Gas Wok Super Range with Soup Warmer. Top Panel Constructed with deep drawn dome for both the wok and the soup warmer. Includes Wok Holder and Wall-Mounted Faucet. Lever is positioned at knee level for ergonomic operation of an oriental. Compatible installation with others 90 Wok Super Range Series.

ITEM# : \_\_\_\_\_

MODEL# : \_\_\_\_\_

NAME : \_\_\_\_\_

SN : \_\_\_\_\_

#### MAIN FEATURE

- Powerful 31 kW burner reinforced with efficient atmospheric burner.
- Unit to be installed free standing.
- Slanted top panel, ensuring water to go in to the back drain.
- Equipped with top panel cooling water system.

#### CONSTRUCTION

- All Exterior panel in 304 type of stainless steel.
- Full weld top panel of the wok for maximum hygienic.
- Top mounted by 1.2mm of Stainless Steel.
- Adjustable  $\pm 25$  mm Stainless Steel leg.

#### INCLUDED ACCESSORIES

- Ignition Hand Lighter

#### OPTIONAL ACCESSORIES

- N/A

APPROVAL : \_\_\_\_\_



PT. NAYATI INDONESIA  
www.nayati.com  
nayati@nayati.com

The company reserves the right to make modifications to the products without prior notice. All information correct at time of printing.  
2018.01.04



Modular Cooking –Oriental  
Gas Wok Range  
NGWR 9-90 W1S1

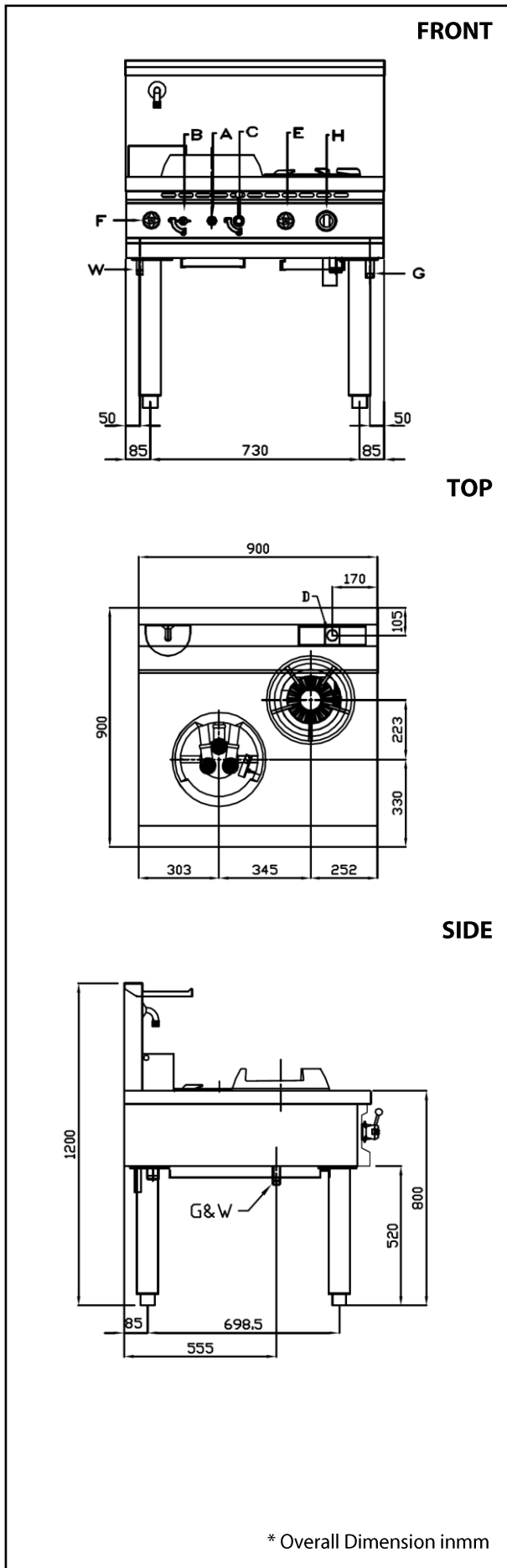

**GAS**

|                  |   |                         |
|------------------|---|-------------------------|
| Gas Consumption  | : | 31 Kw<br>(26,660kCal/h) |
| Gas Type Option  | : | G20,G25,G30/G31         |
| Gas Connection   | : | ¾"                      |
| LPG Gas Pressure | : | G30: 28 mbar            |

**KEY INFORMATION**

|                            |   |          |
|----------------------------|---|----------|
| Cooking surface wok        | : | Ø 280 mm |
| Cooking surface pot holder | : | Ø 280 mm |
| Drain                      | : | Ø 1 ¼"   |
| Water inlet                | : | Ø ½"     |
| Direct heat emission       | : | -        |
| Latent heat emission       | : | -        |
| Steam emission             | : | -        |
| Net weight                 | : | -        |
| Shipping height            | : | -        |
| Shipping width             | : | -        |
| Shipping depth             | : | -        |
| Shipping volume            | : | -        |

**APPROVAL** : \_\_\_\_\_

