

RID
Cod. 22643700

Riduttore fuochi
Flame reducer
Reducteur feux
Flammenreduzierer

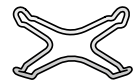

CUCINA ELETTRICA • ELECTRIC STOVE • FORNEAU ELECTRIQUE • ELEKTRO-HERD

PG2Q700
Cod. 31642300

Piastra ghisa
Cast iron plate
Plaque en fonte
Gusseisenplatte

390x574 mm

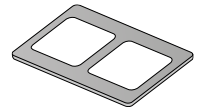

PG2T700
Cod. 31642500

Piastra ghisa
Cast iron plate
Plaque en fonte
Gusseisenplatte

390x574 mm

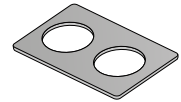

CUCINA A INDUZIONE • INDUCTION COOKER • CUISINE À INDUCTION • INDUKTION-HERD

WOK
Cod. 22645000

Pentola per wok
Wok pan
Marmite pour wok
Wok-pfanne



PENTOLA • BOILING PAN • MARMITE • KOCHKESSEL

CP1
Cod. 31615200

Cesto forato 1/1 - 55 Litri
Basket 1/1 - 55 Liters
Panier 1/1 - 55 Litres
Korb 1/1 - 55 Liter

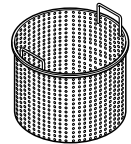

CP2
Cod. 31615400

2 cesti forati 1/2 - 55 Litri
2 baskets 1/2 - 55 Liters
2 paniers 1/2 - 55 Litres
2 Korbe 1/2 - 55 Liter

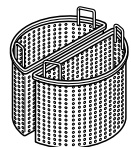

GVP
Cod. 27885500

Grasso per il rubinetto di scarico delle pentole
Grease for the discharge valve
Graisse pour robinet de chasse d'eau
Schmiermittel für kochkessel

1 Kg



BRASIERA • BRATT PAN • SAUTEUS • BRÄTER

CU-P
Cod. 27885100

Lubrificante al rame per brasiere
Grease copper for tilting bratt pans
Graisse de cuivre pour sauteuse basculante
Kupfer-Schmiermittel für Kippbrät-pfanne



FRY TOP • FRY TOP • GRILLADE • BRATPLATTE

SPL
Cod. 22975000

Spatola liscia per Fry top
Smooth scraper
Raclette lisse
Glatte Spachtel

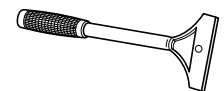

SPR
Cod. 22974900

Spatola rigata per Fry top
Grooved scraper
Raclette nervurée
Gerillte Spachtel

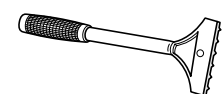

TPTO
Cod. 31976600

Tappo in teflon ovale
Oval teflon stopper
Bouchon de teflon oval
Oval Teflonpfropfen

